

MONASH GRATED INLET

A LOW MAINTENANCE SOLUTION FOR PASSIVE IRRIGATION OF STREET TREES



In collaboration with the City of Monash's engineering team, SVC Civil has developed a fully-contained, easy-install precast kerb product that collects and filters road-level rainwater for the **passive irrigation of street trees**. This significantly reduces the need for frequent, manual watering.

HOW THE SYSTEM WORKS

Stormwater runoff from the road travels into the kerb channel and drains into the inlet through the 8mm openings at the grated entry.

The MGI unit contains a filtration system to remove debris, using a silt basket with varying mesh apertures (6mm & 1mm) to capture small and medium particles.

The filtered stormwater exits the unit through an outlet pipe that feeds into an underground structural soil vault system, which helps to maintain a healthy tree root system to spur growth.

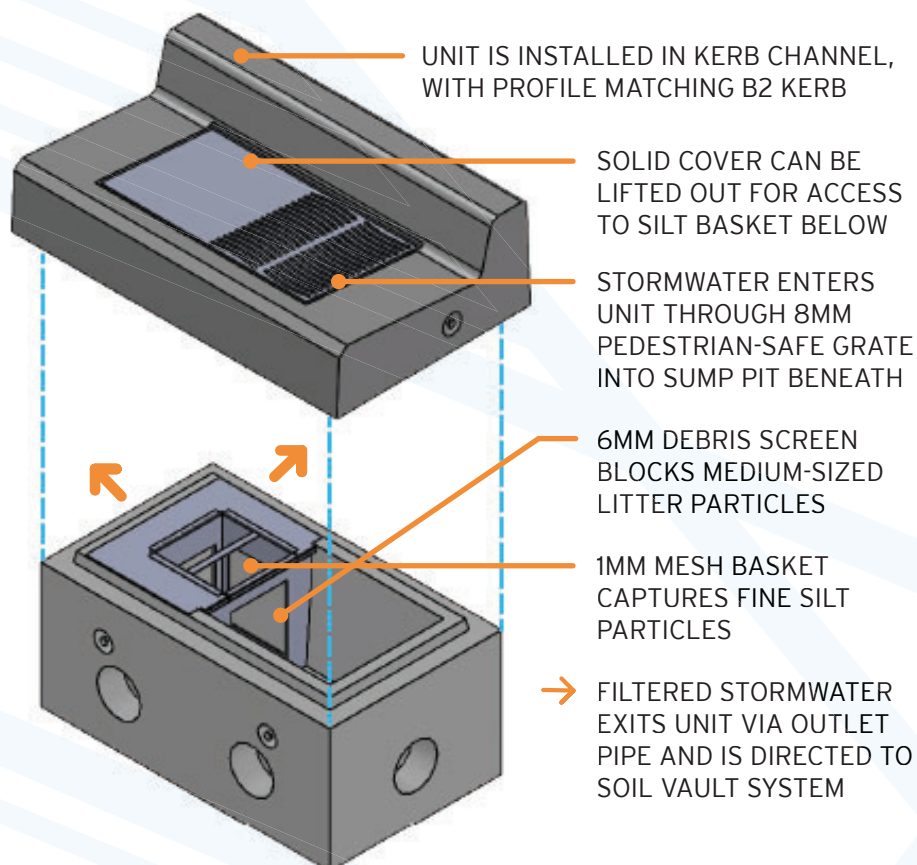

EXAMPLE SITE CONFIGURATION

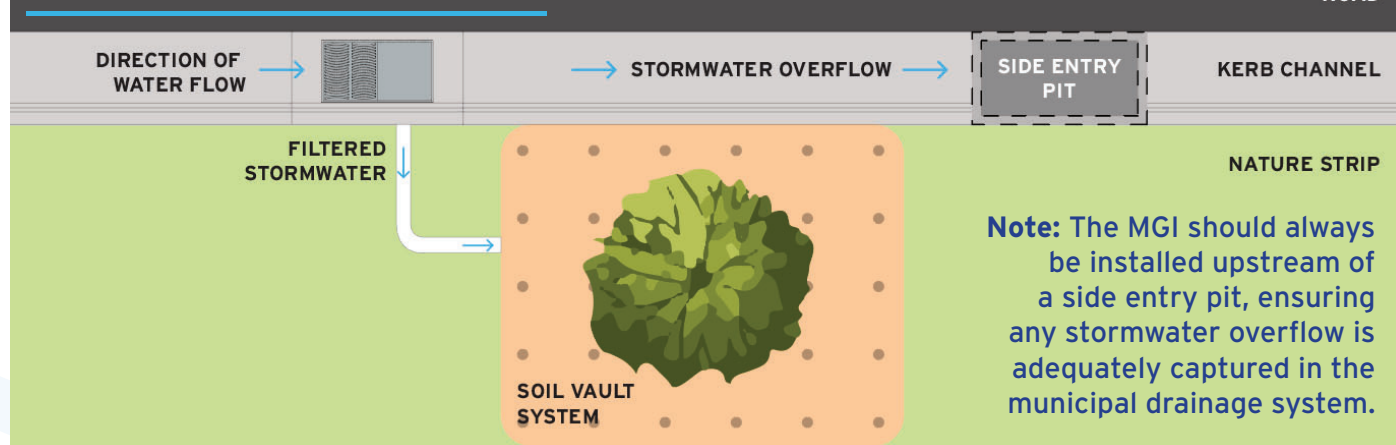

sales@svc.com.au



38 JAPADDY ST
MORDIALLOC 3195
1300 287 782

2 CHAFFEY ST
THOMASTOWN 3074
03 9460 3813

10 REEVES CT
BREAKWATER 3219
1300 287 782

MONASH GRATED INLET

A LOW MAINTENANCE SOLUTION FOR PASSIVE IRRIGATION OF STREET TREES



▲ Precast catch pit and B2 encasement containing lift-out cover and grate



▲ Two-part insert featuring Class C pedestrian-safe grate and solid cover



▲ Easily removable steel silt basket with 6mm mesh screen at front plate

EASY INSTALLATION: The Monash Grated Inlet is a fully contained precast unit designed for efficient installation. The internal silt basket components are pre-assembled and the solid cover and grate can be interchanged to suit any orientation. Six knockouts in the catch pit enable easy connection of an outlet pipe.

LOW MAINTENANCE: Once installed, the MGI provides a low-maintenance solution for council crews, only requiring a 3-6 month maintenance cycle (dependent on environmental conditions) to clear out debris that has accumulated in the catch pit and lift-out silt basket, which can be easily accessed. This provides significant time and labour savings compared to weekly or fortnightly manual watering of street trees.

PROMOTING SUSTAINABILITY: The MGI is made using the SVC Eco concrete mix containing low-carbon cement and recycled plastic waste, which reduces CO₂ emissions and consumes less virgin raw materials. With an impressive design life of 50 years, the MGI offers a viable long-term solution for maintaining council trees.

FITTING INSTRUCTIONS

1. Insert the top and front catchment plate into the precast catch pit on the outlet side.

2. Insert the debris basket, ensuring it rests over the front plate. The 6mm mesh edge should be aligned with the front plate, while the remaining edges of the basket are the 1mm mesh.

3. Insert the encasement over the catch pit and basket, ensuring the cover is correctly aligned so that the solid cover is over the silt basket and the grate is over the inlet chamber.

